

DRIVE LINE

• Engine Kits	1
• Cummins I.D.	2
• Exedy (Daikin Clutch) Kits	3
• E-Z Rider Comfort-Pedal Clutch Kits	4
• Eaton Fuller Clutch Kits	6
• Spicer Uni Joints	9
• Rockwell/Meritor Diff Head Assemblies	15
• Eaton/Dana Diff Head Assemblies	18
• Eaton/Roadranger	19
• ZF Transmission Componentry	21
• Hendrickson Suspension	22
• Trailer Axles	23
• Japanese Torque Rod Bushes	23
• Wrenches	24
• Wheel Studs and Nuts	24

**S
E
C
T
I
O
N**

D



HINO Engine kits



A large range of Genuine Hino Engine Kits to suit New Zealand domestic models.

Mack Engine Overhaul Kits

for:

Mack E6 2VH Part # N57GC376Kit*

Mack E6 4VH Part # N57GC373AKit*

Mack E9 (400-525 hp) Part # N57GC375AKit*

Mack E9 (400-525 hp) Part # A215SB204

Mack E7 (300-400 hp) Part # N215SB217Kit*
(16.9:1 CR)

Mack EA7 (454 hp) Part # N215SB218Kit*
(15.3:1 CR)

Mack E7 2-piece piston upgrade
Part # 215SB198G

* includes oil and fuel filters

Features:

- New pistons, pins and retainers
- New piston rings
- New piston liners
- New big end bearings
- New main bearing set
- New gasket set upper and lower
- New head gaskets
- Warranty: 2 year unlimited km on cylinder rebuild kits, 1 year unlimited km on bearings and gaskets



Mack Engine Overhaul Kits



Remanufactured Muzzle Loader Overhaul Kits

for:

E7 VMAc 1 & 2 Part # 215SB277KX*
(375-454 hp)

E7 E-TECH Part # 215SB280KX*
(350-470 hp) Non CCRS

* Core charge applies

Features:

- New piston rings
- New bearings and gaskets
- New piston skirts and liners
- Reman piston crowns, connecting rods
- Reman snap rings and wrist pins
- Warranty: 2 year unlimited km on cylinder rebuild kits, 1 year unlimited km on bearings and gaskets



Reman Muzzle Loader Overhaul Kits

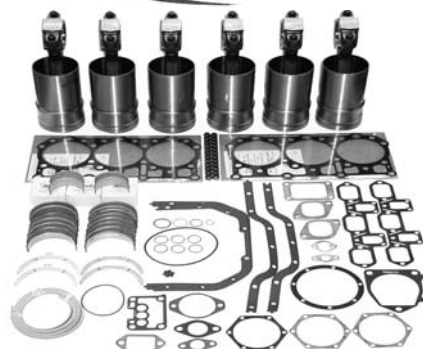

Genuine Parts



Engine Identification

STEP 1

Locate engine data plate on front of engine (Timing cover).

STEP 2

Locate and record from data plate following information:

- Engine Model
- Engine Serial Number
- Control Parts List (C.P.L.) Number

PRODUCT IDENTIFICATION INFORMATION

Data plates should be referred for parts identification

2	Engine No.	S.O. No.			
1	Model	Ref. No.			
	Advertised	Engine Cert Indent.	C.I.D.	Family	C.P.L.
	Cont. No.				
	Date of mfg.	Warranty start date			
Manufactured by Cummins Engine Co.					

1. Model designation
2. Engine serial number
3. Control parts list

EXEDY

(Daikin Clutch)

Original Equipment Suppliers to:

Mitsubishi

Nissan

Hino

ISUZU



Clutch kits available for:

HINO:

ISUZU:

MITSUBIHI:

NISSAN:

Also: Ford Trader, Mazda T3500



From 3 tonne upwards

**“Original equipment” quality
at competitive pricing**

E-Z RIDER COMFORT-PEDAL CLUTCH KIT

PART NUMBER	DIAMETER		SHAFT SIZE		CERAMIC CLUTCH FACINGS	ORGANIC CLUTCH FACINGS	COAXIAL SPRINGS IN DISC	FREE TRAVEL	PLATE LOAD	GREASE TYPE BEARING	TORQUE RATING LBS/FT	CLUTCH BRAKE
	14"	15.5"	1.75"	2"								
Z-EZ10803482B	<input type="checkbox"/>	<input type="checkbox"/>	<input type="checkbox"/>	<input type="checkbox"/>	<input type="checkbox"/>	<input type="checkbox"/>	8	<input type="checkbox"/>	3600	<input type="checkbox"/>	1150	
APPLICATION: Isuzu 340HP Engine EXZ18JX3F, CXZ18QX3T, CXH18VX3T Isuzu 270HP Engine												
Z-EZ10803582B	<input type="checkbox"/>	<input type="checkbox"/>	<input type="checkbox"/>	<input type="checkbox"/>	<input type="checkbox"/>	<input type="checkbox"/>	8	<input type="checkbox"/>	3600	<input type="checkbox"/>	1150	
APPLICATION: Hino N4526 FS270, FS271, FS275, FS631 Isuzu 250HP Engine EX18DX, EXR16DXT N5032, FS631, FS635 N4132, SH633												
Z-EZ10805059B	<input type="checkbox"/>	<input type="checkbox"/>	<input type="checkbox"/>	<input type="checkbox"/>	<input type="checkbox"/>	<input type="checkbox"/>	8	<input type="checkbox"/>	3600	<input type="checkbox"/>	1400	
APPLICATION: Isuzu Cummins L10 - Non Electric												
Z-EZ10839174B	<input type="checkbox"/>	<input type="checkbox"/>	<input type="checkbox"/>	<input type="checkbox"/>	<input type="checkbox"/>	<input type="checkbox"/>	10	<input type="checkbox"/>	3600	<input type="checkbox"/>	1650	
APPLICATION: Mack E6, E9 Cummins 14 litre non electronic over 400HP Light/medium work applications Disc hub size medium (215mm) Note: Disc only 4 buttons												
Z-EZ10839177B	<input type="checkbox"/>	<input type="checkbox"/>	<input type="checkbox"/>	<input type="checkbox"/>	<input type="checkbox"/>	<input type="checkbox"/>	8	<input type="checkbox"/>	3600	<input type="checkbox"/>	1250	
APPLICATION: Hino N5036, FS660, FS665, FY664 Mack E6-2VH, ENDTB866 Engine Isuzu Mitsubishi engines up to 1070 LBS/FT N4533, SS330 FY335 Disc hub size small (180mm)												
Z-EZ10839178B	<input type="checkbox"/>	<input type="checkbox"/>	<input type="checkbox"/>	<input type="checkbox"/>	<input type="checkbox"/>	<input type="checkbox"/>	10	<input type="checkbox"/>	4000	<input type="checkbox"/>	1450	
APPLICATION: High torque applications with organic facings Cummins 14 litre non electronic Disc hub size medium (215mm)												
Z-EZ10839181B	<input type="checkbox"/>	<input type="checkbox"/>	<input type="checkbox"/>	<input type="checkbox"/>	<input type="checkbox"/>	<input type="checkbox"/>	8	<input type="checkbox"/>	3600	<input type="checkbox"/>	1400	
APPLICATION: Mack E6-2VH, ENDTB866 Engine Cummins 14 litre non electronic under 400HP (370-380HP) Disc hub size small (180mm)												

E-Z RIDER COMFORT-PEDAL CLUTCH KIT

PART NUMBER	DIAMETER		SHAFT SIZE		CERAMIC CLUTCH FACINGS	ORGANIC CLUTCH FACINGS	COAXIAL SPRINGS IN DISC	FREE TRAVEL	PLATE LOAD	GREASE TYPE BEARING	TORQUE RATING LBS/FT	CLUTCH BRAKE
	14"	15.5"	1.75"	2"								
Z-EZ10839193B	<input type="checkbox"/>	<input type="checkbox"/>	<input type="checkbox"/>	<input type="checkbox"/>	□ (4B)		10	<input type="checkbox"/>	4000	<input type="checkbox"/>	1860	
APPLICATION: Mack EN9-525HP, EN9-500HP Heavy Duty Application Disc hub size medium (215mm)												
Z-EZ10893551	<input type="checkbox"/>	<input type="checkbox"/>	<input type="checkbox"/>	<input type="checkbox"/>	□ (4B)		9	<input type="checkbox"/>	3600	<input type="checkbox"/>	MACK 1650	
APPLICATION: Mack E6-4VH Late, E7-400HP, EA7-410HP E-Tech (V MAC 111) with CL798 clutch Disc hub size large (245mm)												

EATON Fuller EASY-PEDAL CLUTCH KIT

PART NUMBER	DIAMETER		SHAFT SIZE		CERAMIC CLUTCH FACINGS	ORGANIC CLUTCH FACINGS	COAXIAL SPRINGS IN DISC	FREE TRAVEL	PLATE LOAD	GREASE TYPE BEARING	TORQUE RATING LBS/FT	CLUTCH BRAKE
	14"	15.5"	1.75"	2"								
Z-10803457A	<input type="checkbox"/>	<input type="checkbox"/>	<input type="checkbox"/>	<input type="checkbox"/>	<input type="checkbox"/>	<input type="checkbox"/>	8	<input type="checkbox"/>	3200	<input type="checkbox"/>	1000	<input type="checkbox"/>
APPLICATION: Isuzu 340HP Engine EXZ18JX3F, CXZ18QX3T, CXH18VX3T Isuzu 270HP Engine												
Z-10803461B	<input type="checkbox"/>	<input type="checkbox"/>	<input type="checkbox"/>	<input type="checkbox"/>	<input checked="" type="checkbox"/>	<input type="checkbox"/>	8	<input type="checkbox"/>	2800	<input type="checkbox"/>	1000	<input type="checkbox"/>
APPLICATION: Isuzu 340HP Engine EXZ18JX3F, CXZ18QX3T, CXH18VX3T Isuzu 270HP Engine												
Z-10803539A	<input type="checkbox"/>	<input type="checkbox"/>	<input type="checkbox"/>	<input type="checkbox"/>	<input type="checkbox"/>	<input type="checkbox"/>	8	<input type="checkbox"/>	3200	<input type="checkbox"/>	1000	<input type="checkbox"/>
APPLICATION: Hino N4526 FS270, FS271, FS275, FS631 Isuzu 250HP Engine, EX18DX, EXR16DXT N5032, FS631, FS635 N4132, SH633												
Z-10803490A	<input type="checkbox"/>	<input type="checkbox"/>	<input type="checkbox"/>	<input type="checkbox"/>	<input checked="" type="checkbox"/>	<input type="checkbox"/>	8	<input type="checkbox"/>	3200	<input type="checkbox"/>	1400	<input type="checkbox"/>
APPLICATION: Isuzu Cummins L10 - Non Electric												
Z-10803591A	<input type="checkbox"/>	<input type="checkbox"/>	<input type="checkbox"/>	<input type="checkbox"/>	<input checked="" type="checkbox"/>	<input type="checkbox"/>	8	<input type="checkbox"/>	2400	<input type="checkbox"/>	1050	<input type="checkbox"/>
APPLICATION: Foden Late Model, Mack CH666 Metroliner, Cummins ISM												
Z-10894077A EP 2000™	<input type="checkbox"/>	<input type="checkbox"/>	<input type="checkbox"/>	<input type="checkbox"/>	<input type="checkbox"/>	<input type="checkbox"/>	8	<input type="checkbox"/>	3200	<input type="checkbox"/>	1250	<input type="checkbox"/>
APPLICATION: Mitsubishi												
Z-10894080A EP 2000™	<input type="checkbox"/>	<input type="checkbox"/>	<input type="checkbox"/>	<input type="checkbox"/>	<input checked="" type="checkbox"/>	<input type="checkbox"/>	8	<input type="checkbox"/>	3200	<input type="checkbox"/>	1400	<input type="checkbox"/>
APPLICATION: Disc hub size small (180mm)												
Z-10893574A EP 2000™	<input type="checkbox"/>	<input type="checkbox"/>	<input type="checkbox"/>	<input type="checkbox"/>	<input checked="" type="checkbox"/>	<input type="checkbox"/>	10	<input type="checkbox"/>	3600	<input checked="" type="checkbox"/>	1650	<input type="checkbox"/>
APPLICATION: Mack E6, E9 Cummins 14 litre non electric over 400HP Light/medium work applications Disc hub size medium (215mm) Note: Disc only 4 buttons												

Eaton Fuller EASY-PEDAL CLUTCH KIT

PART NUMBER	DIAMETER		SHAFT SIZE		CERAMIC CLUTCH FACINGS	ORGANIC CLUTCH FACINGS	COAXIAL SPRINGS IN DISC	FREE TRAVEL	PLATE LOAD	GREASE TYPE BEARING	TORQUE RATING LBS/FT	CLUTCH BRAKE
	14"	15.5"	1.75"	2"								
Z-10893577A EP 2000™	<input type="checkbox"/>	<input type="checkbox"/>	<input type="checkbox"/>	<input type="checkbox"/>	<input type="checkbox"/>	<input type="checkbox"/>	8	<input type="checkbox"/>	3600	α 1 ZERK	1250	<input type="checkbox"/>
APPLICATION: Hino N5036, FS660, FS665, FY664 SS5036, SS663 N4533, SS330 FY335 Mack E6-2VH, ENDTB866 Engine Isuzu Mitsubishi engines up to 1070 LBS/FT Disc hub size small (180mm)												
Z-10893578A EP 2000™	<input type="checkbox"/>	<input type="checkbox"/>	<input type="checkbox"/>	<input type="checkbox"/>	<input type="checkbox"/>	<input type="checkbox"/>	10	<input type="checkbox"/>	4000	α 1 ZERK	1450	<input type="checkbox"/>
APPLICATION: High torque applications with organic facings Cummins 14 litre non electronic Disc hub size medium (215mm)												
Z-10893581A EP 2000™	<input type="checkbox"/>	<input type="checkbox"/>	<input type="checkbox"/>	<input type="checkbox"/>	α (4B)	<input type="checkbox"/>	8	<input type="checkbox"/>	3600	α 1 ZERK	1400	<input type="checkbox"/>
APPLICATION: Mack E6-2VH, ENDTB866 Engine Cummins 14 litre non electronic under 400HP (370-380HP) Disc hub size small (180mm)												
Z-10893521A EP 2000™	<input type="checkbox"/>	<input type="checkbox"/>	<input type="checkbox"/>	<input type="checkbox"/>	α (6B)	<input type="checkbox"/>	6 (VCT)	<input type="checkbox"/>	4000	α 1 ZERK	1860	<input type="checkbox"/>
APPLICATION: Cummins M11 - L10 Celect 350HP, Mack CX Vision (Mack part # 11HB29420) Disc hub size large (245mm)												
Z-10893526A EP 2000™	<input type="checkbox"/>	<input type="checkbox"/>	<input type="checkbox"/>	<input type="checkbox"/>	α (6B)	<input type="checkbox"/>	6 (VCT)	<input type="checkbox"/>	4000	α 2 ZERK	2050	<input type="checkbox"/>
APPLICATION: Mack EN9-525HP, EA9-575HP, EA9-610HP V8 Engine Cummins 14 litre electronic Flywheel of 10.125" or Greater ID Disc hub size large (245mm)												
Z-10893591A EP 2000™	<input type="checkbox"/>	<input type="checkbox"/>	<input type="checkbox"/>	<input type="checkbox"/>	α (6B)	<input type="checkbox"/>	6 (VCT)	<input type="checkbox"/>	4000	α 2 ZERK	MACK 2050	<input type="checkbox"/>
APPLICATION: Mack E7-400, EA7-427/454, 460/470 E Tech (V Mac III) Mack EN9-525HP, EA9-575HP, EA9-610HP V8 Engine Cummins 14 litre electronic Disc hub size large (245mm)												
APPLICATION: Mack E6-4VH Late, E700 400HP, EA7-410HP E-Tech (VMAC III) with CL798 Clutch Disc hub size large (245mm)												

EATON Fuller EASY-PEDAL CLUTCH KIT

PART NUMBER	DIAMETER		SHAFT SIZE		CERAMIC CLUTCH FACINGS	ORGANIC CLUTCH FACINGS	COAXIAL SPRINGS IN DISC	FREE TRAVEL	PLATE LOAD	GREASE TYPE BEARING	TORQUE RATING LBS/FT	CLUTCH BRAKE
	14"	15.5"	1.75"	2"								
Z-10893593A EP 2000™	<input type="checkbox"/>	<input type="checkbox"/>	<input type="checkbox"/>	<input type="checkbox"/>	α (6B)		10	<input type="checkbox"/>	4000	α 2 ZERK	1750	<input type="checkbox"/>
APPLICATION: Mack EN9-525HP, EN9-500HP Heavy Duty Application Disc hub size medium (215mm)												
	<input type="checkbox"/>		<input type="checkbox"/>	<input type="checkbox"/>	α (6B)	7 (VCT Plus)		<input type="checkbox"/>	4000	<input type="checkbox"/>	2250	<input type="checkbox"/>
APPLICATION: vehicle fitted with EATON 18 speed 14" spline input shaft												

EATON Fuller STAMPED ANGLE SPRING CLUTCH KIT

PART NUMBER	DIAMETER		SHAFT SIZE		CERAMIC CLUTCH FACINGS	ORGANIC CLUTCH FACINGS	COAXIAL SPRINGS IN DISC	FREE TRAVEL	PLATE LOAD	GREASE TYPE BEARING	TORQUE RATING LBS/FT	CLUTCH BRAKE
	14"	15.5"	1.75"	2"								
Z-10770116A	<input type="checkbox"/>	<input type="checkbox"/>	<input type="checkbox"/>	<input type="checkbox"/>			8	<input type="checkbox"/>	2800	<input type="checkbox"/>	800	<input type="checkbox"/>
APPLICATION: L8000 Louisville												
	<input type="checkbox"/>		<input type="checkbox"/>	<input type="checkbox"/>	α (6B)		8	<input type="checkbox"/>	2000	<input type="checkbox"/>	900	<input type="checkbox"/>
APPLICATION: L8000 Louisville												
Z-1077036A	<input type="checkbox"/>		<input type="checkbox"/>	<input type="checkbox"/>	α (6B)		8	<input type="checkbox"/>	2000	<input type="checkbox"/>	900	<input type="checkbox"/>
APPLICATION: FL80 Freightliner												

SPICER UNI-JOINT KITS



INSIDE SNAP RING STYLE REPLACEMENT KITS

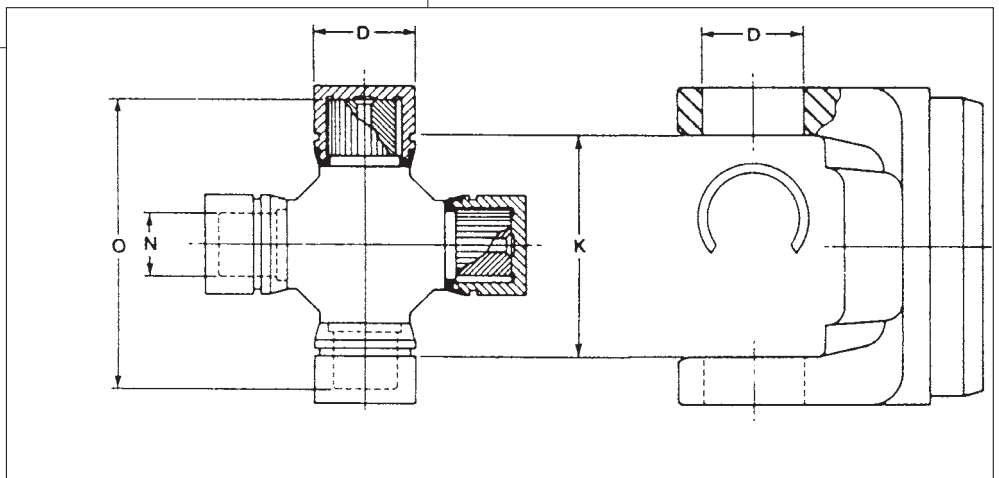

K		D		N	O	Lube Fitting	Original Equipment		Spicer Part No.
Snap Ring Dimension		Bearing Diameter		Cross Trunnion Diameter	Cross Overall Length		Manufacturer	Series	
Inches	mm	Inches	mm						
1.500"		.938"		.505"	2.078"	Yes	Spicer	1000-SG	Z-5103X

SPICER UNI-JOINT KITS



2 OUTSIDE SNAP RING & 2 WING BEARING STYLE CONVERSION REPLACEMENT KITS

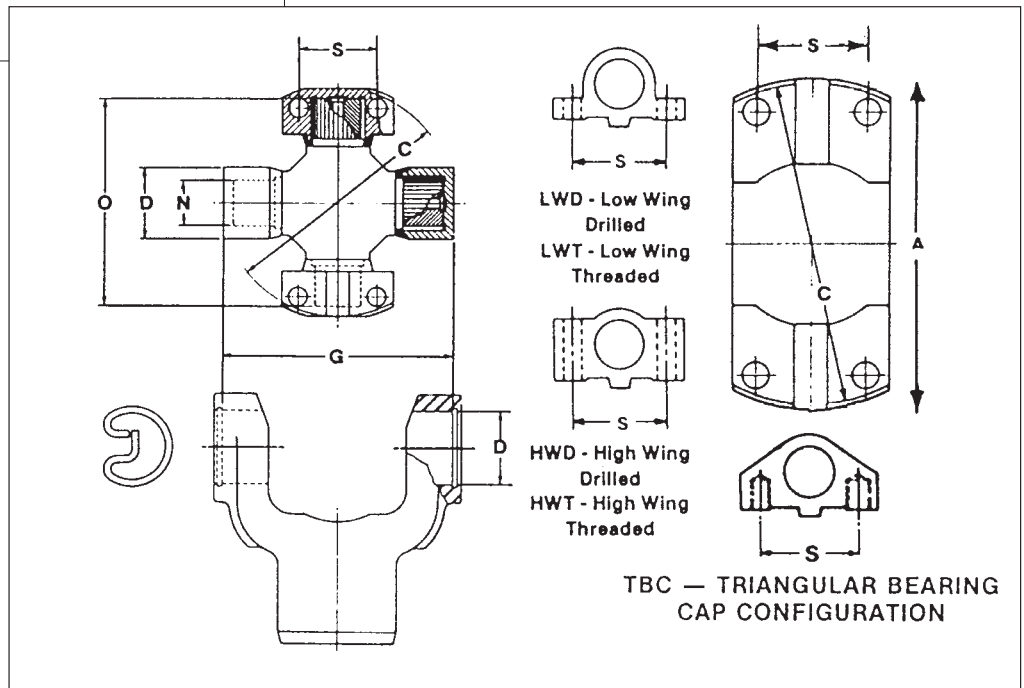

C	S	G	D	N	O	Wing and Round Bearing Type	In Order to Convert		Spicer Part No. (Contains Lube Fitting)
							From Mechanics / Rockwell Series	To Spicer Series	
Pilot Diameter	Centerline to Centerline Bearing Bolt Hole	Snap Ring Dimension	Bearing Diameter	Cross Trunnion Diameter	Cross Overall Length				
8.250"	2.813"	8.094"	2.185"	1.380"	7.594"	2 (HWD) 2 Round	9C/92N 88WB	1880	Z-5186X

SPICER UNI-JOINT KITS

2 WING BEARING & 2 BEARING PLATE STYLE CONVERSION REPLACEMENT KITS

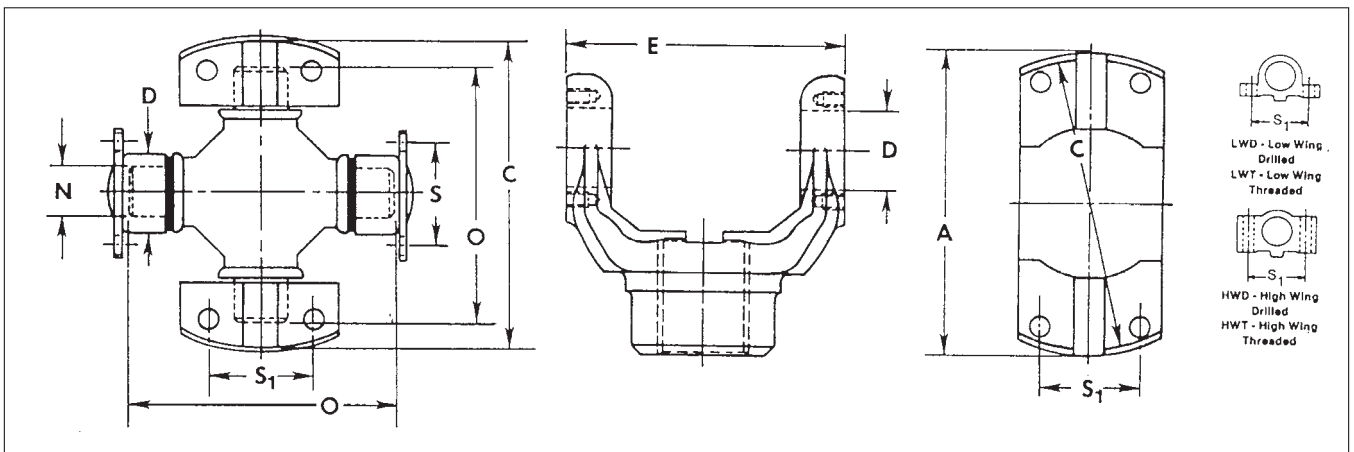
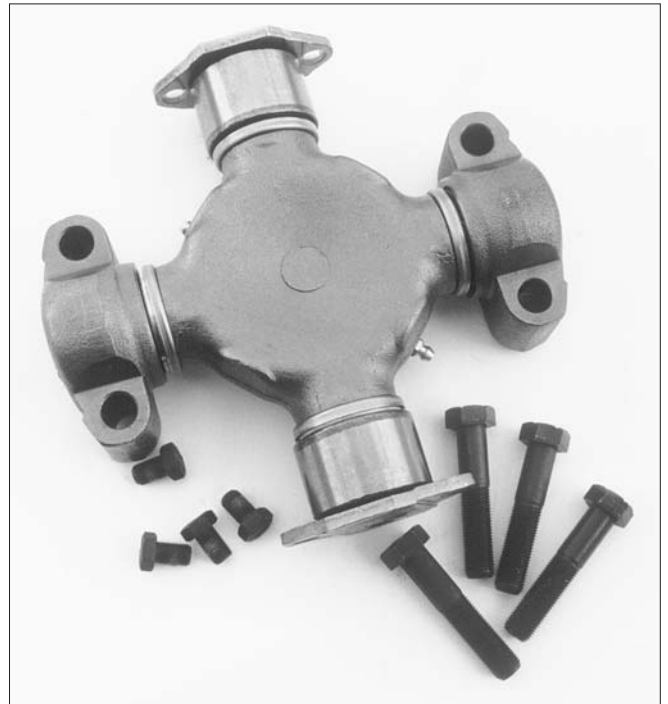

C	S ₁	E	D	S	N	O	Wing and Bearing Plate Type	A	In Order to Convert		Spicer Part No. (Contains Lube Fitting)
									Swing Diameter	From Mechanics Rockwell Series	
Pilot Diameter	Wing Centerline to Centerline Bearing Bolt Hole	Yoke Dimension	Bearing Diameter	Bearing Plate Centerline to Centerline Bearing Bolt Hole	Cross Trunnion Diameter	Cross Overall Length					
8.250"	2.813"	7.547"	1.938"	2.438"	1.300"	7.250"	2 (HWD) 2B/P	8.375	9C/92N 88WB	1810	Z-5324X
8.250"	2.813"	8.094"	2.187"	2.813"	1.380"	7.594"	2 (HWD) 2B/P	8.375	9C/92N 88WB	1880	Z-5326X

SPICER UNI-JOINT KITS



BEARING PLATE STYLE REPLACEMENT KITS

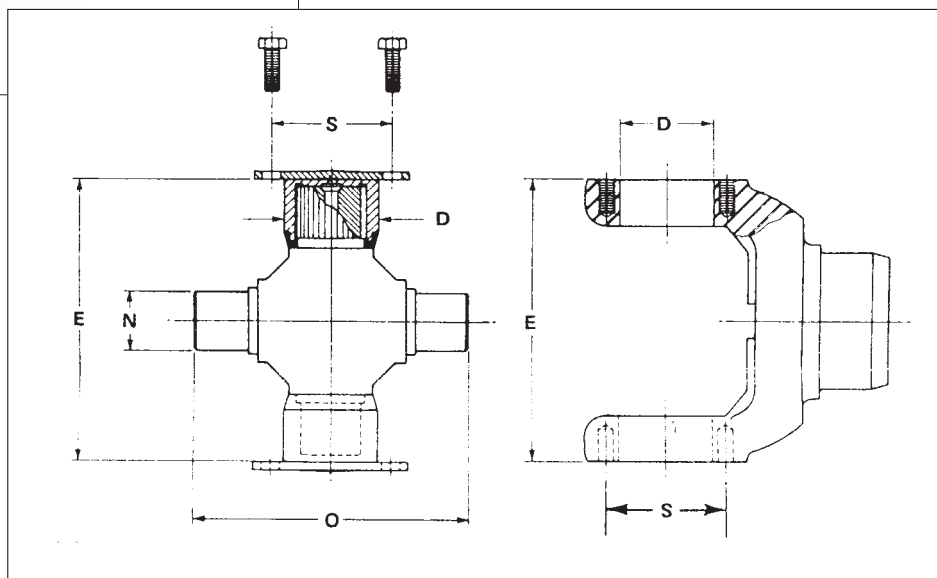

E Yoke Dimension	D Bearing Diameter	S Centerline to Centerline Bearing Bolt Hole	N Cross Trunnion Diameter	O Cross Overall Length	Original Equipment		Spicer Part No. (Contains Lube Fitting)
					Manufacturer	Series	
5.312"	1.875"	2.308"	1.272"	5.001"	Spicer	1610	Z-5279X
6.094"	1.937"	2.432"	1.298"	5.784"	Spicer	1710	Z-5280X
6.594"	2.312"	2.432"	1.681"	6.283"	Spicer	1800	Z-5124X
7.547"	1.937"	2.432"	1.298"	7.242"	Spicer	1810	Z-5281X

SPICER UNI-JOINT KITS

2 BEARING PLATE, 2 STRAP STYLE BEARING AND HALF ROUND REPLACEMENT KITS



**BEARING
RETAINER
STRAP KIT**

- 1/2 Round
- Suits 1810 Drive Line

Part No. Z-657018X

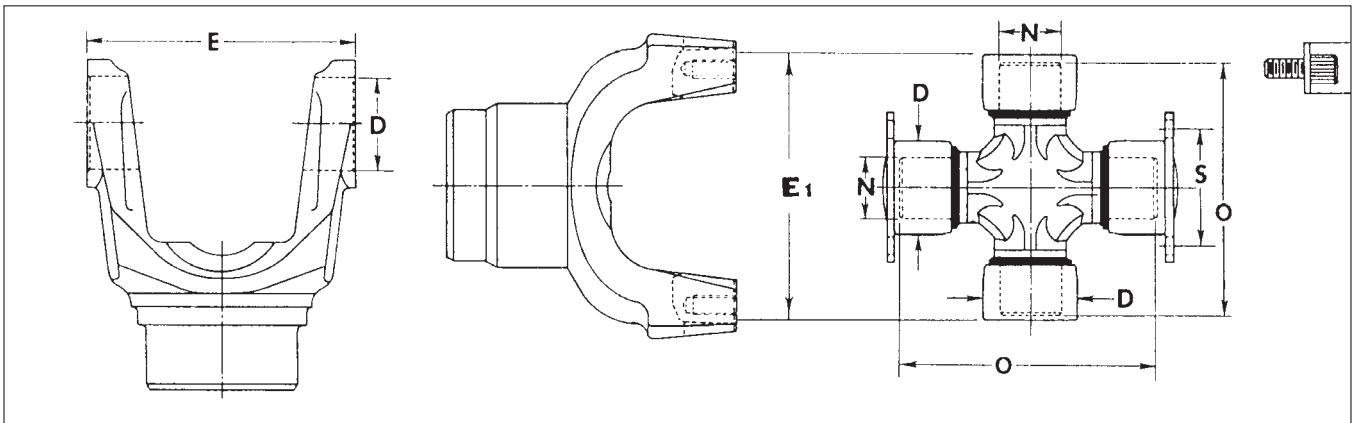

E	E ₁	D	S	N	O	Original Equipment		Spicer Part No. (Contains two Lube Fittings)
						MFG.	Series	
Yoke Dimension 6.094"	Yoke Dimension 6.094"	Bearing Diameter 1.937"	Centerline to Centerline Bearing Bolt Hole 2.432"	Cross Trunnion Diameter 1.298"	Cross Overall Length 5.784"	Spicer	1710	Z-5675X
7.547"	7.547"	1.937"	2.432"	1.298"	7.242"	Spicer	1810	Z-5676X

The value of Powertrain® replacement U-Joints

SPICER®

Thrust pad minimises wear.

Bearing Race I.D. crowning reduces trunnion galling and flaking and compensates for yoke deflection.

Lube Retention Valve maintains lubricant in bearing area.

Uniform case hardening provides maximum wear surface and resists surface distortion.

Forged journal cross, carburized and hardened for extended service.

Grooved trunnions ensure maximum flow of grease to needle bearings.

Tapered Roller Ends ensure needle retention.

Grease fitting facilitates maintenance.

Bearing with "Long Life" Seals retains lubrication and excludes harmful

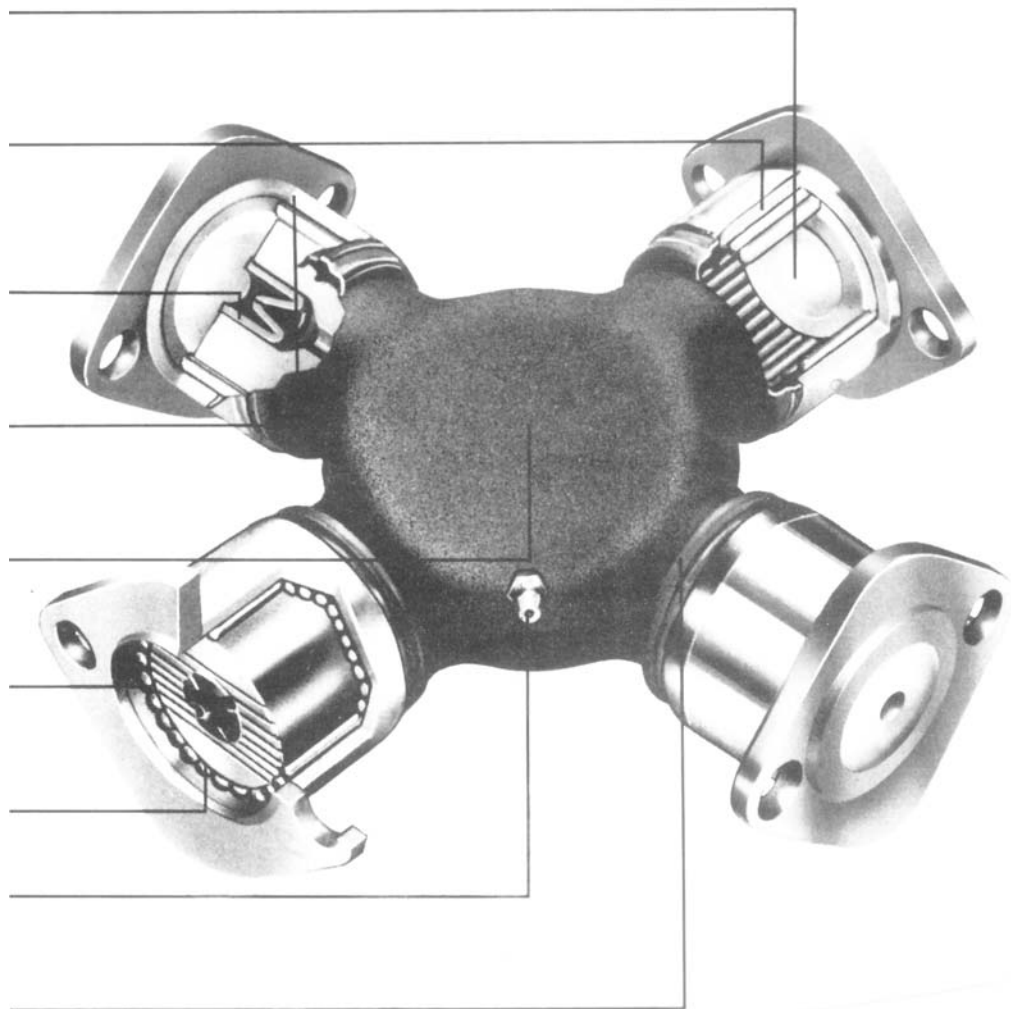

Z-279 for 1610 Series
Z-280 for 1710 Series
Z-281 for 1810 Series



Powertrain.® Because anything less than Dana technology isn't worth the chance.



Rockwell

PARTS & SERVICE FOR:

Axles:

- RT40 - 140/145
- RT46 - 160
- RT52 - 180
- RT52 - 153
- SSHD

Suspensions:

- AC6P
- AC6S
- AC6T

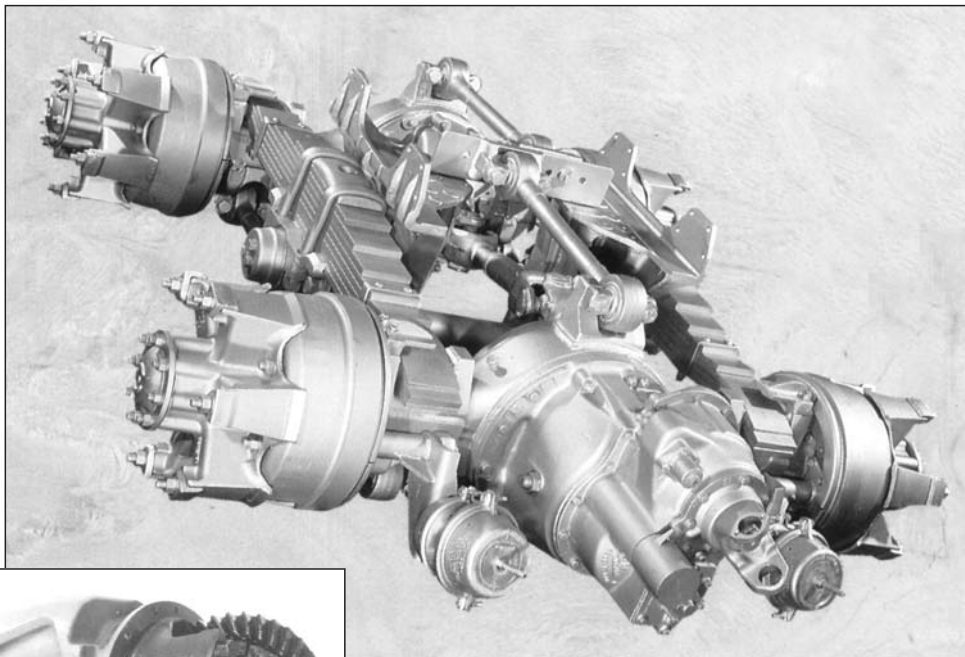

SSHD & RT Series Diff Heads
Ratio made to suit

Front Z-SHDA-FRONT
Rear Z-SHRA-REAR



MERITOR™

A Heritage of Rockwell Technology



ROCKWELL/MERITOR DIFF HEADS

SSHD FRONT (Without Cross-Locks)

Z-SHDA-3.73	Z-SHDA-3.90
Z-SHDA-4.11	Z-SHDA-4.89

SSHD REAR (Without Cross-Lock)

Z-SHRA-3.73	Z-SHRA-3.90
Z-SHRA-4.11	Z-SHRA-4.89

RT52-153 FRONT (With Cross-Locks)

201131-0/3:73R	201131-0/3:90R
201131-0/4:11R	201131-0/4:30R

RT52-153 REAR (With Cross-Locks)

RT153RM/3:73	RT153RM/3:90
RT153RM/4:11	RT153RM/4:3

RP20-145 (RT40-145) FRONT

Z-RP20145411	4.11 Ratio	(Without Cross-Locks)
Z-RPL20145411	4.11 Ratio	(With Cross-Locks)
Z-RP20145430	4.30 Ratio	(Without Cross-Locks)
Z-RPL20145430	4.30 Ratio	(With Cross-Locks)
Z-RP20145529	5.29 Ratio	(Without Cross-Locks)

RR20-145 (RT40-145) REAR

Z-RR20145411	4.11 Ratio	(Without Cross-locks)
Z-RRL20145411	4.11 Ratio	(With Cross-Locks)
Z-RR20145430	4.30 Ratio	(Without Cross-Locks)
Z-RRL20145430	4.30 Ratio	(With Cross-Locks)
Z-RRL20145529	5.29 Ratio	(With Cross-Locks)

NOTE: Ratio changes are an option.



ROCKWELL/MERITOR DIFF HEADS

RP23-160 (RT46-160) FRONT

Z-RP23160410	4.11 Ratio	(Without Cross-Locks)
Z-RPL23160410	4.11 Ratio	(With Cross-Locks)
Z-RP23160430	4.30 Ratio	(Without Cross-Locks)
Z-RPL23160430	4.30 Ratio	(With Cross-Locks)

RR23-160 (RT46-160) REAR

Z-RR23160410	4.11 Ratio	(Without Cross-locks)
Z-RRL23160410	4.11 Ratio	(With Cross-Locks)
Z-RR23160430	4.30 Ratio	(Without Cross-Locks)
Z-RRL23160430	4.30 Ratio	(With Cross-Locks)

NOTE: Ratio changes are an option



EATON/DANA

DIFF HEADS

DDH40-P FRONT (With Cross-Locks)

Z-510301.C	Diff Head 4:11 Ratio
Z-510302.C	Diff Head 4:33 Ratio

DSH40-P FRONT (Without Cross-Locks)

Z-510289.C	Diff Head 4:11 Ratio
Z-510290.C	Diff Head 4:33 Ratio

RDH40 REAR (With Cross-Locks)

Z-510241.G	Diff Head 4:11 Ratio
Z-510242.G	Diff Head 4:33 Ratio

RSH40 REAR (Without Cross-Locks)

Z-510136.G	Diff Head 4:11 Ratio
Z-510259.G	Diff Head 4:33 Ratio

Note:

The above Diff Heads are DIRECT replacements for the Eaton Dana DD454 & RS454 Diff Heads with Cross-Locks.

Ratio changes are an option.

EATON

ROAD RANGER, TWIN SPLITTER, 5109, 6109, 8209 SERIES

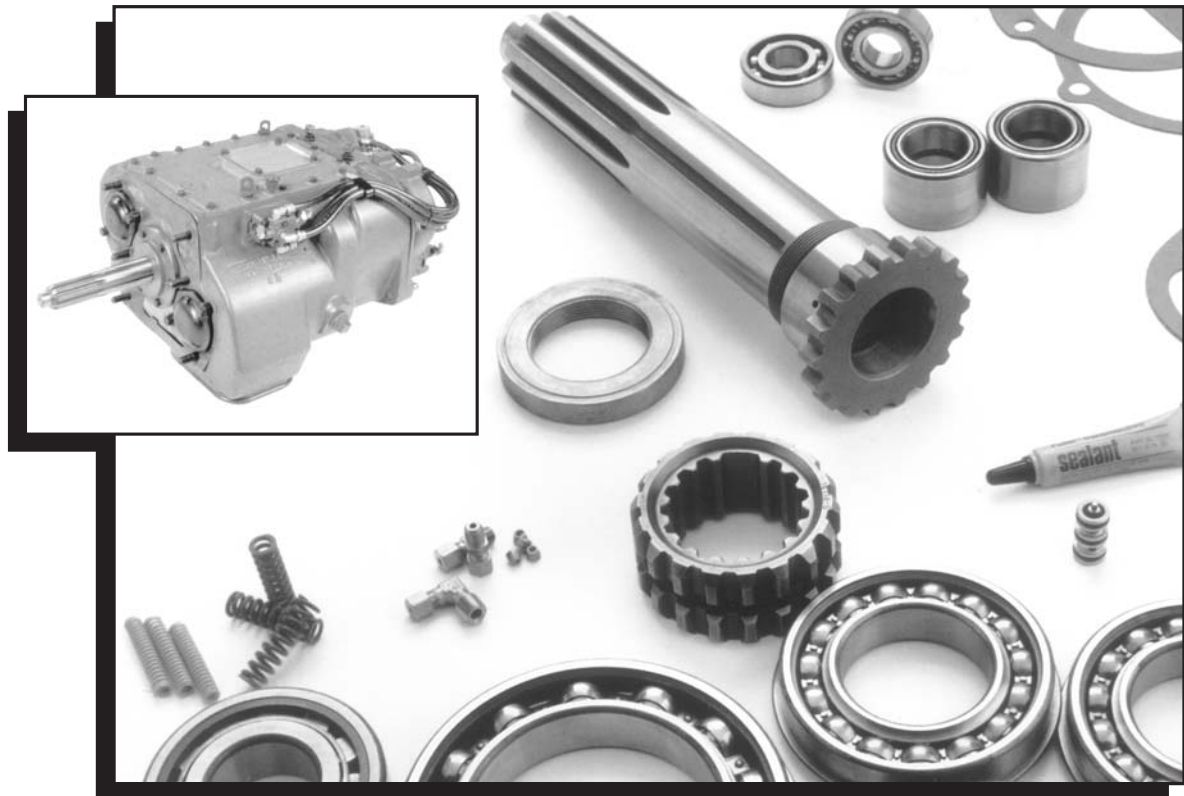

**For Genuine Durability
and Reliability
with Competitive Pricing**



EATON TRANSMISSIONS

13 Speed

RTLO16713AX	13 Speed Overdrive	1650 lbs.ft.
-------------	--------------------	--------------

15 Speed

RTX15715R	15 Speed Overdrive	1650 lbs.ft.
-----------	--------------------	--------------

18 Speed

Z-RTLO14718BX	18 Speed Overdrive	1450 lbs.ft.
Z-RTLO16918BX	18 Speed Overdrive	1650 lbs.ft.
Z-RTLO18718BX	18 Speed Overdrive	1850 lbs.ft.
Z-RTLO18918B	18 Speed Overdrive	1850 lbs.ft.
Z-RTLO20918BX	18 Speed Overdrive	2050 lbs.ft.
Z-RTLO22918BX	18 Speed Overdrive	2250 lbs ft

European Transmissions

H-6109	9 Speed Synchromesh
--------	---------------------



Transmissions and Gear Componentry

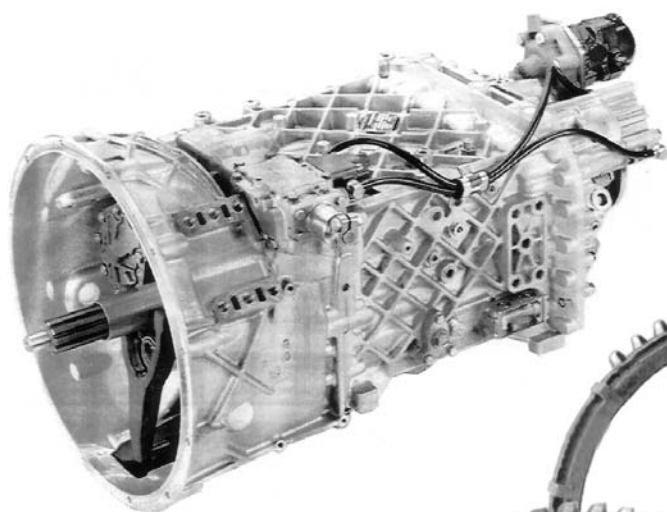

ZF is the leader in the field of synchromesh transmissions for the heavy commercial vehicle industry. High quality and reliability with competitive pricing on complete transmission assemblies and gear componentry.



HENDRICKSON

TRUCK & TRAILER SUSPENSIONS AND PARTS

**CHECK OUT
OUR FULL
RANGE!**

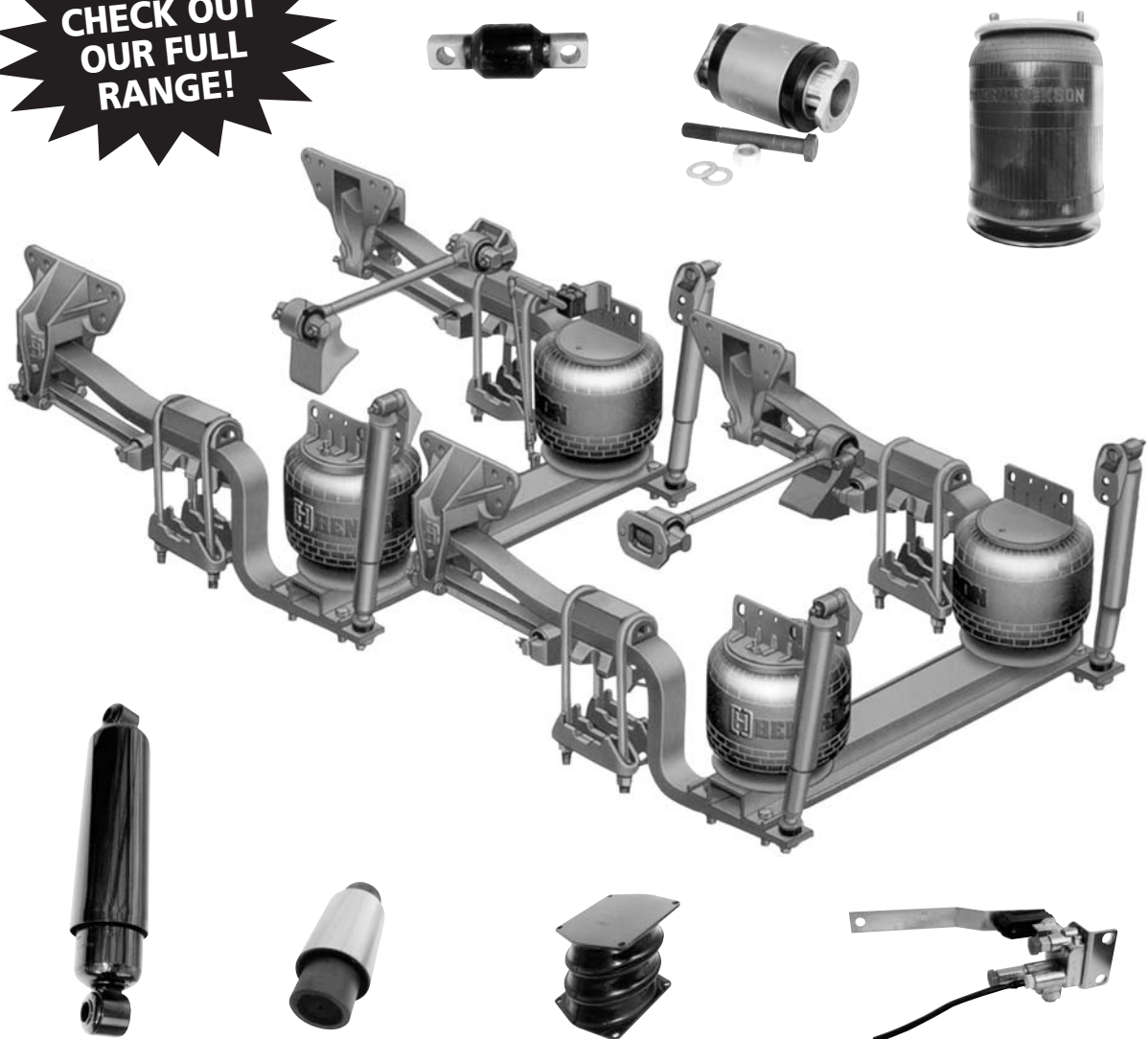

TRAILER AXLE ASSEMBLIES

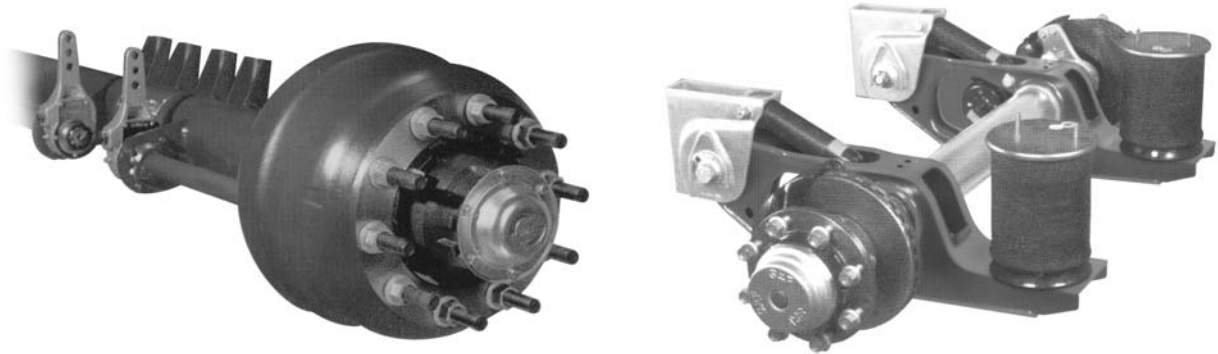

**Range from 15" Low Loader to 22.5 Standard axles.
Available in drum brake or disc brake assemblies.**

TORQUE ROD BUSHES

FEATURES:

- **SPHERICAL BALL PIN**

The central portion of the ball pin is spherical which promotes longer life by evenly spreading load and stress applied to the cushioning rubber.

- **TEFLON THRUST WASHER**

Provides longer service life by maintaining surface contact with ball pin and bush during movement.

- **LUBE PAD SUPPORT**

Combined with teflon thrust washer to support and lubricate ball pin which insures greater durability and economical operation.

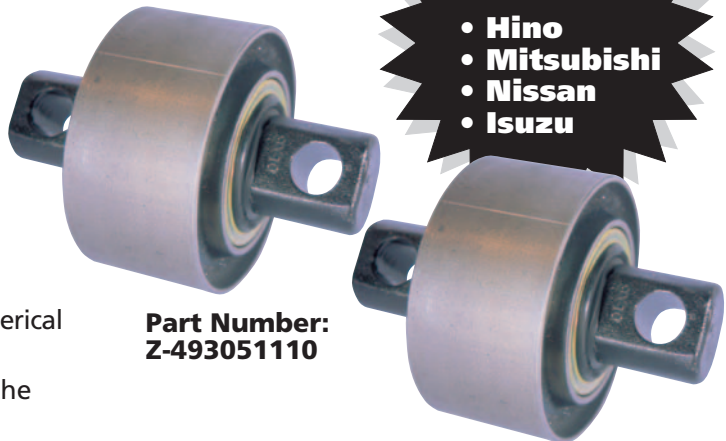

SUITS

- Hino
- Mitsubishi
- Nissan
- Isuzu

**Part Number:
Z-493051110**

- **STEEL WASHER**

Securely staked on both sides of bush to insure internal components are held firmly in place.

- **DUST SEAL**

Made of durable rubber minimising cuts and abrasion wear. An internal spring insures greater sealing on ball pin reducing internal contamination (dirt).

WRENCHES FOR TRUCK & TRAILER WHEELS

Made from Forged Chrome Nickel Alloy Steel - All Wrenches 16" Long

 <p>DAYTON - GUNITE - ERIE - WEBB SPOKE WHEELS</p>	PART No.	APPLICATION
	Z-E5856	1 ¹ / ₁₆ " and 1 ¹ / ₄ " Hex for ⁵ / ₈ " - 11 ³ / ₄ " - 10 Nuts
 <p>HUB - PILOTED WHEELS</p>	PART No.	APPLICATION
	Z-E6038	24mm and 33mm Hex for Metric Wheel Nuts
 <p>HEX HANDLE FOR WRENCHES</p>	PART No.	APPLICATION
	Z-E5854	³ / ₄ " Hex x 22" long fits all of the above wrenches

SPOKE WHEEL AND RIM STUDS

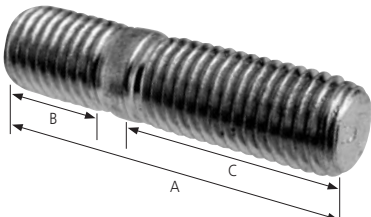
	PART No.	REPLACES	A	THREAD	THREAD LENGTH	
	Z-E4956A	Dayton 08-005715 Goodyear ST-29 Gunite WP147	3"	³ / ₄ " -10	B 1 ¹ / ₁₆ "	C 1 ³ / ₄ "

SPOKE WHEEL RIM NUT

	PART No.	DAYTON	ERIE	GUNITE	WEBB	NWRA	THREAD	HEX
	Z-E4963BK - GRADE 5	08-005716	5260	WP148	74710	N-40	³ / ₄ " - 10	1 ¹ / ₄ "